



PLAYWORK

CONFERENCE

FEB 16-19

VAL VERDE, CA

2

17

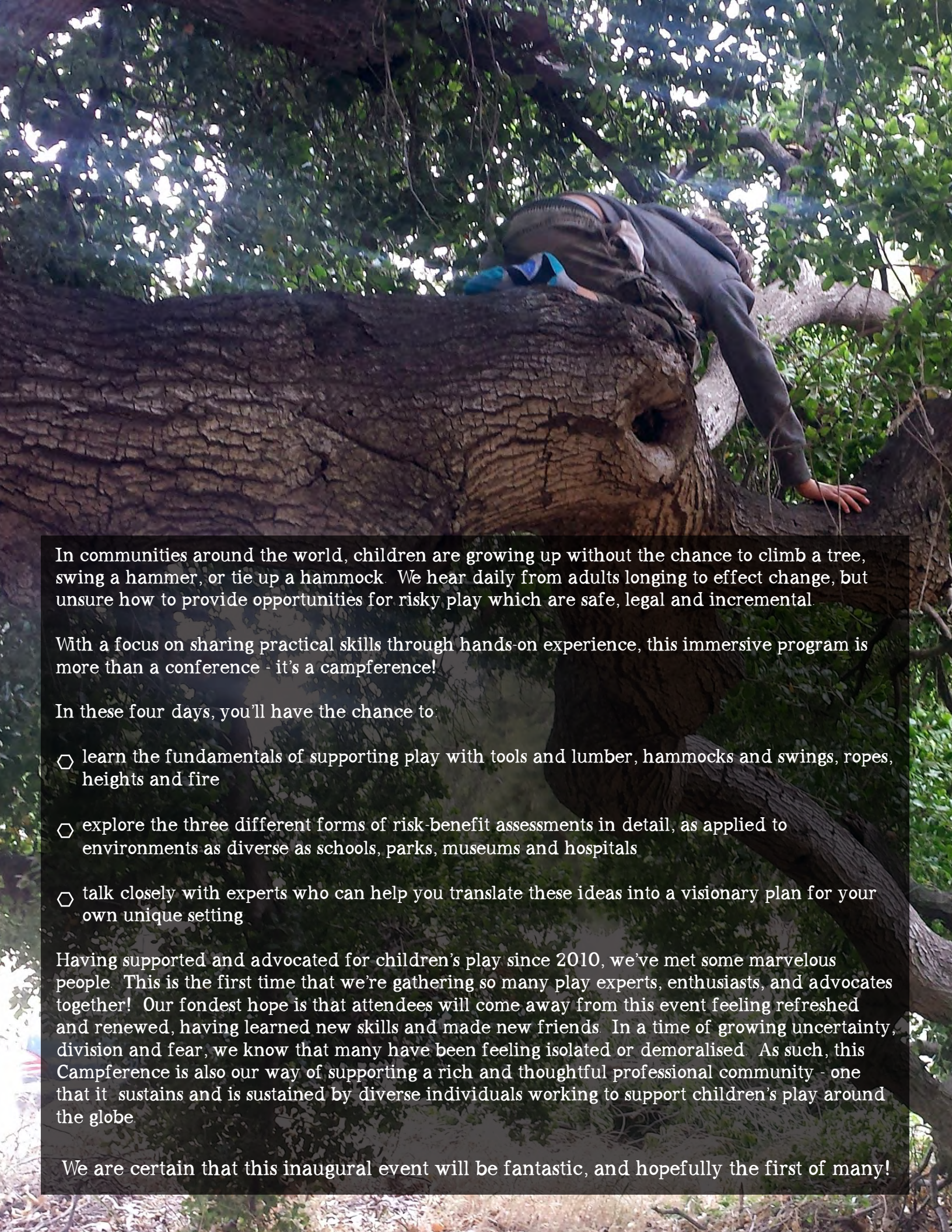

WELCOME PACKET

A person wearing a grey hoodie and blue pants is climbing a large, thick tree trunk. The person is positioned on the right side of the trunk, with their hands and feet gripping the bark. The background is filled with dense green foliage and sunlight filtering through the leaves.

In communities around the world, children are growing up without the chance to climb a tree, swing a hammer, or tie up a hammock. We hear daily from adults longing to effect change, but unsure how to provide opportunities for risky play which are safe, legal and incremental.

With a focus on sharing practical skills through hands-on experience, this immersive program is more than a conference - it's a campference!

In these four days, you'll have the chance to

- learn the fundamentals of supporting play with tools and lumber, hammocks and swings, ropes, heights and fire
- explore the three different forms of risk-benefit assessments in detail, as applied to environments as diverse as schools, parks, museums and hospitals
- talk closely with experts who can help you translate these ideas into a visionary plan for your own unique setting

Having supported and advocated for children's play since 2010, we've met some marvelous people. This is the first time that we're gathering so many play experts, enthusiasts, and advocates together! Our fondest hope is that attendees will come away from this event feeling refreshed and renewed, having learned new skills and made new friends. In a time of growing uncertainty, division and fear, we know that many have been feeling isolated or demoralised. As such, this Campference is also our way of supporting a rich and thoughtful professional community - one that it sustains and is sustained by diverse individuals working to support children's play around the globe.

We are certain that this inaugural event will be fantastic, and hopefully the first of many!



YOUR ORGANIZERS

Pop-Up Adventure Play began in 2010 with the intention of developing a holistic, low-cost and community-based approach to supporting children's play. Our goal from the beginning was to create introductory models for people to begin rebuilding community around play, at the grassroots level. Today, we are proud to also offer ongoing support and training, and to be encouraging the growth of an international community of playwork students and practitioners in person and online.

At pop-up adventure playgrounds, children of all ages, backgrounds and abilities can explore, transform, create and destroy in a safe, supportive environment. Inherently joyful and inclusive, these events powerfully demonstrate the value and social potential of play in the public sphere. We work with a variety of stakeholders in children's lives, including city parks and recreation teams, art galleries and museum staff, family support organisations and health specialists, as well as parents and children themselves, to improve children's opportunities for play throughout their lives.

We currently support independent pop-up adventure playground organisers in more than a twenty countries around the world, including

the US, UK, Colombia, Egypt and Mexico. In 2014, we toured the USA. In 2015 we toured Australia, and then carried on going, around the world. In summer 2017, we will visit sites from east to west across Canada.

We recognise that the barriers children face to their play are complex and multifaceted. The pop-up adventure playground model is not a complete solution, but it is a place for organisers to start. These events have proved very effective in welcoming local residents to a conversation about risk, freedom and enjoyment, and helped people of all ages reconnect around play. Many organisers who began with pop-ups are now leading on-going programs or weaving play support into their work in other settings, or developing permanent adventure playground sites. We profiled several in our book *The New Adventure Playground Movement: How Communities across the USA are Returning Risk and Freedom to Childhood*.

In our 7th year of supporting play and playwork internationally, we are extremely proud to co-host the first-ever playwork conference in the USA.



SUZANNA



ANDY



MORGAN



YOUR HOSTS

Santa Clarita Valley (SCV) Adventure Play is a group that advocates free play for children and adults. We believe that physical and mental space for free play is an essential piece of a healthy and happy life, as well as access to nature, a supportive community, and a measure of the benefits of risk.

Since our formation in 2014, SCV Adventure Play has held numerous pop-up adventure playgrounds throughout Los Angeles County for private and public events. We have presented at numerous colleges, symposiums, and community centres on the topic of playwork and its benefits in the public and domestic space. We recently partnered with Santa Clarita Valley International Charter school and ran a loose parts recess initiative for their K1-8th grades. Our story was published in Pop-Up Adventure Play's *The New Adventure Play Movement: How Communities Across the USA are Returning Risk and Freedom to Childhood* and will be included in upcoming publications by Joan Almon.

Santa Clarita Valley Adventure Play was founded by Jeremiah Dockray and Erica Larsen-Dockray in 2014. After more than ten years of working in post production in the reality TV industry, Jeremiah began pursuing a career in playwork and working with kids. In addition to managing SCV Adventure Play, he also is a preschool teacher at A Little Patch of Earth Preschool in Newhall, CA. Alongside the adventure play business and her art practice, Erica is an adjunct faculty of experimental animation at the California Institute of the Arts, is a teaching artists at Inner-city Arts, and directs her co-founded Calibraska summer animation and art workshops in her hometown of Scottsbluff, NE.

While working on a playwork course assignment in 2014, Jeremiah came across an abandoned 2 acre park in their community of Val Verde, CA which is now the developing home of Eureka Villa Adventure Playground. It will be the only adventure playground in Los Angeles County and the seventh permanent site in the US.

Dear Campference Attendees,

We could not be more excited to host this event and cannot wait to meet all the incredible souls gathering on our budding permanent adventure playground, Eureka Villa.

We are confident the conversations and experiences will change us deeply in our own playwork paths. Let us know how we can help make your stay as rustically comfortable as possible!

Love,
Jeremiah and Erica



Santa Clarita Valley
**ADVENTURE
PLAY**



www.scvadventureplay.com + info@scvadventureplay.com + 661.670.8663
Jeremiah Dockray + Erica Larsen-Dockray



PRESENTERS



HEADLINER



FRASER
BROWN

We are proud to welcome Professor Fraser Brown as our keynote speaker. Fraser Brown is the world's only

Professor of Playwork, and head of the UK's oldest playwork department (Leeds Beckett University). His extensive research and practical knowledge spans many years and has proved crucial in establishing Playwork as a recognised, professional field of study.

He is author of *Playwork: Theory and Practice*, co-author of *Rethinking Children's Play* and editor of *Foundations of Playwork Practice*. However, he is perhaps best known for his powerful work with children in Romanian orphanages, and his team's moving accounts of play's therapeutic and transformative power for some of the world's most deprived children.

His most recent book, "Play And Playwork: 101 Stories Of Children Playing" features some wonderful reflections of play and will be available to view at the Campference.

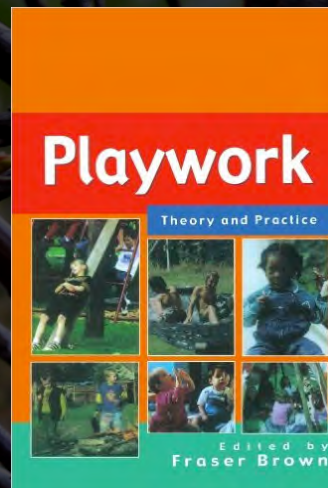

SPECIAL GUESTS

ERIN DAVIS

Erin Davis is a filmmaker and podcast producer. Her documentary film *THE LAND* premiered at the Full Frame Documentary Film Festival in 2015 and was subsequently featured on NPR, *The Atlantic* and Katie Couric's *Katie* show and is used in classrooms and living rooms to inspire discussion about the spectrum of freely chosen play. Her radio work has aired on *All Things Considered* and been featured by *Transom.org*. She teaches the popular Winter term course *Sound & Story: An Introduction to Podcasting* at Middlebury College. She lives in Middlebury, Vermont and has a one year old son who puts her hack theories to the test every day.

JILL WOOD

Jill Wood holds a Bachelor of Fine Arts in Studio Art and a Masters of Library and Information Science from the University of Texas at Austin. As a child growing up in a suburb of Los Angeles, her favourite subject in school was recess and some of her most memorable hours were spent riding bikes, looking for sea slugs, and carefully labeling her rock collection. She is founder and Director of Adventure Play, an after school program at The Parish School, designed to support exploratory, free play, and co-founder of Bayou City Play, an organisation that promotes child-directed play through temporary loose parts playgrounds at Shriner's Hospital for Children, and in public spaces throughout the City of Houston. She is also a school librarian and dreams of creating a combined book/playmobile on wheels.

JEREMIAH DOCKRAY

Jeremiah Dockray is a preschool teacher and playworker, TV and film editor, and a co-founder of SCV Adventure Play and Eureka Villa. In 2012, he discovered the concept of Adventure Playgrounds, and while fulfilling an assignment for the Playworker Development Course Jeremiah discovered a 30 year abandoned park in his community of Val Verde, CA. A few months later Eureka Villa was born as Jeremiah and his wife Erica purchased the plot to develop into the seventh permanent adventure playground in the US and the first in Los Angeles County. Currently Jeremiah devotes the majority of his time to developing SCV Adventure play through offering consultations, pop-up adventure playgrounds, Eureka Villa site visits and presentations on the importance of play. He has presented at the Ithaca Play Symposium, CalArts, and College of the Canyons.

ERICA LARSEN-DOCKRAY

Erica Larsen-Dockray is a native of Scottsbluff, NE. Aside from Co-Founding SCV Adventure Play, Erica is currently an adjunct faculty at her alma mater, the California Institute of the Arts (CalArts), in the Film/Video school's experimental animation program where she teaches under camera animation techniques and critical studies of female representation in animation. In addition to her

work as a teaching artist, Erica has co-founded Calibraska Arts Initiative where she returns to her home state with California based artists to facilitate multi-generational summer art camps. She also is a founding member of the North American Adventure Play Association, serves as the Public Relations Director on the Val Verde Civic Association and is a leader on the Santa Clarita Valley CalArts Alumni Chapter.

ANDY HINCHCLIFFE

Andy has more than ten years experience in playwork, beginning as a volunteer with out-of-school provision, moving onto managing and developing a playwork-guided community and children's centre in Bradford. He graduated in 2012 with a First-Class Honours Degree in Playwork following work with Fraser Brown's charity in Romania and later researching theories around deep, dark and criminal play.

Andy has been involved with Pop-Up Adventure Play since 2012, supporting the 2014 US national tour, 2015 World Tour and has recently co-worked alongside SCV Adventure Play on a loose-parts recess initiative in the Santa Clarita Valley.

SUZANNA LAW

Suzanna began as a mobile playworker, or playranger, in socio-economically deprived neighbourhoods in Manchester, UK. She then pursued a second BA, and graduated in 2012 with a First-Class Honours Degree in Playwork. At the same time, she helped to found Pop-Up Adventure Play in both the UK and US, and was Lead Playworker during a 2-month residency on Governors Island in NYC. Based in the UK, she is currently working towards her PhD in Playwork at Leeds Beckett University. At Pop-Up Adventure Play, she leads on project coordination including all four Pop-Ups Tours, and manages online communications for all social media platforms.

MORGAN LEICHTER-SAXBY

Morgan trained as a playworker and play ranger in London, first with Penny Wilson and then Bob Hughes. In 2010, she co-founded Pop-Up Adventure Play US to address the lack of playwork knowledge in her home country. Since then she has presented at over a dozen conferences, including the keynote at the Children's Development Forum in Bogota, and trained frontline staff at new and established sites. At Pop-Up Adventure Play, Morgan leads on training and coordinates writing projects such as *The Loose Parts Manual*, the *Pop-Up Play Shop Toolkit* and a chapter in the recently released book *"Playing It Up - With Loose Parts, Playpods, and Adventure Playgrounds"*. Morgan is based in the US but also working towards a PhD at Leeds Beckett University in the UK. Together, Morgan and Suzanna designed and delivered the Playworker Development Course, and completed tours of the US, Australia, and the world.

FELLOW PRESENTERS

ALEX COTE

Ithaca, NY USA

Alex was a member of staff at the Ithaca Children's Garden for several years, recently finishing as their Head Playworker. She has consulted with schools and summer camps on play, landscape design, and staffing approaches, and is shortly starting work at Eureka Villa. Alex found playwork through an initial interest in playground design, but she has since been completely captivated by playwork's focus on the deeper issues of children's rights. To this end, she is as likely to be found with her hands raised, at the pointy end of a stick wielded by a child warden, as she is at the front of a room talking to grown-ups about how and why to embrace the very play that brought her to surrender in the dirt the day before. She loves it all.

MEGAN DICKERSON

San Diego, CA USA

Megan Dickerson, San Diego, CA, USA: Megan is Manager of Exhibition Development at The New Children's Museum, a unique museum in which each "exhibit" is a one-of-a-kind art installation. On any given day, you might find her playing peek-a-boo with a toddler in Wobbleland, a space with giant fruit and vegetable sculptures, or meeting with a partner artist to plan logistics for a new art installation. Prior to The New Children's Museum, Megan spent ten years at Boston's Children's Museum developing pop-up play spaces in urban parks, health-focused interventions in public housing, and numerous exhibits and programs. Her work as an artist and independent curator focuses on public art, and has included such projects as the Bumpkin Island Art Encampment, a five-day island-bound arts residency in Boston Harbor, and Willy Wonka in Smellovision, a series of outdoor film screenings with choreographed scent deployments. Megan holds a BA in History from the University of California, Los Angeles and an MA in Play and Playwork from the University of Gloucestershire, and writes and publishes regularly about art, play and playwork. For more information, visit www.takeplayseriously.org

CHRIS MARTIN

United Kingdom, EU

Chris is a UK based playworker, play writer/researcher, and playwork activist. He has an MA in Play and Playwork and is currently starting fieldwork for his PhD, examining the interaction between children and mobile digital technology in their outdoor play. He is on the board of the International Play Association (England, Wales and Northern Ireland), a postgraduate fellow of the Royal Geographical Society (with Institute of British Geographers), and has published and delivered academic and professional papers in the UK and internationally. He has extensive knowledge and expertise in national workforce development, facilitated the All Party Parliamentary Group on Play, and for over ten years was Na-

tional Playwork Convenor for the Community, Youth and Playworker's Section of Unite the Union, the UK's largest Trade Union. Before that he was chair of the Association of Playworkers (England). He has played an active role on the UK Play Safety Forum, Play Policy Forum, and on Play England's former Strategic Advisory Board. In his spare time he cooks a mean curry, plays in a post-punk band and holds a black belt in Taekwon-Do.

SIMON RIX

United Kingdom, EU

Simon Rix, UK: Self-professed "dangerous radical", Simon has been part of the UK's playwork scene since the age of 17. He has worked on many adventure playgrounds across London, designed consultation programs and worked to inform government policy. Simon co-founded Design and Build (Play), an organization which trains playworkers in construction with children. He now runs Meriden Adventure Playground, a multifaceted community project and adventure playground in Solihull, which is thriving in spite of the difficult context of political austerity. Through this project, he is also involved in research linking adventure playgrounds with public health and fostering resilience. Meriden was also a partner in a film made by the art group Assemble Collective. He regards the adventure playground as a constructed situation which is both disruptive and compensatory, as they both 'rattle the cage of the spectacle' and compensate for environmental deficiencies in the daily lives of children and other community members.

LUKE SUTTON

United Kingdom, EU

Luke has given talks on The Land, playwork and various theories from Cardiff to Eastbourne to Tokyo. He has been a trainee playworker, fully qualified playworker, Resource Officer, Senior Inclusion Playworker and a Senior playworker, where he oversaw the running of five different projects in five different communities. His writings on Environmental Modifications have been published in the Journal of Playwork Practice. He hasn't managed an Adventure Playground yet! A playworker for five and a half years, Luke worked at The Land before, during and after its inception. He has now left to travel the world and explore practice in other countries, and misses the team and kids greatly. At Campference, he'll be telling a series of stories that will hopefully illustrate what makes The Land such a special and unique place. He says: "If anyone sees me around please feel free to pounce and ask me any questions, and I'll apologise now in case I get too overly excited."

EUREKA VILLA



As you know, we'll be hosting this Campference on a real, new adventure playground. The whole event will last from 1pm on 16th February to 1pm on 19th February 2017. There will be two significant happenings taking place as part of the Campference for you to note.

On Friday evening there will be a free screening of "Imagine Kolle 37" and "The Land" at SCVi, a local charter school. This will also include a Q&A panel featuring Erin Davis, Luke Sutton, Michelle Meek (director of Imagine Kolle 37) and Prof Fraser Brown.

On Saturday afternoon, we will be hosting a pop-up adventure playground at Val Verde Park. This will be fully open to the public, and to your involvement during the material collection, site assessment, staging, staffing and reflection stages.

Are you looking to grow your practical playwork skills?

The children at Campference are welcomed to ongoing play sessions, staffed by our marvelous team of professional playworkers. We'll have a sign-up sheet for participants eager to observe staff in action, and build relationships with new mentors.

Open Mic Mornings

If you have stories or information about your background, approach or setting that you would like to share, come on down to the Open Mic(-less) sessions each morning. There will be sign-up sheets where you can choose your 15-minute slot, but there won't be any electricity, so be sure and print out any handouts or images that you want to distribute.

Food, Accommodation and Showers

Meals will be prepared on site and eaten together, with the whole process headed up by our friend Megan Dickerson and her colleagues from the San Diego Children's Museum. Occasionally we may have to muck in and help with prep or to move things around - If we all help a little we will ensure that everyone will get fed and stay happy! Please feel free to bring snacks or beverages from your region to share. In the evenings we will have campfires.

There will be overflow camping in the park next door, with accessible shower rooms attached to the local pool. This isn't luxury camping, but we confidently expect to meet everyone's needs and ensure a fun time for all.

PROGRAM SCHEDULE

Thursday | 2/16/2017 Arrival day

Time	Freedom Forest	Pacific Oak	Palm Grove	Fireside Reflections
7:00 AM				
8:00 AM				
9:00 AM	General Arrival and Set-up Bonanza Eureka Villa Adventure Playground Across from 28710 Madison Way Val Verde, CA 91384			
10:00 AM				
11:00 AM				
12:00 PM				
1:00 PM	Lunch for helpers			
2:00 PM	Welcome to Eureka Villa and Campference			
3:00 PM	Building shelters and bonfires (All) Together, we'll create simple structures for use throughout the festivities.			
4:00 PM	Keynote 1 @ Pacific Oak (Prof. Fraser Brown) Topic: What is the unique relationship between playworkers and children, and how it is created? + Snack share (All) A chance to swap regional snacks from your area with new friends.			
5:00 PM	Dinner			
6:00 PM	Big questions circle @ Pacific Oak This opening conversation will help elicit some of the questions we have brought with us, and how we can use them to open conversations around the fire and beyond.			
7:00 PM	Hide and seek in the dark, followed by baked bananas and s'mores Come out with your flashlight, for some spooky fun in the park next door.			
8:00 PM				
9:00 PM				
10:00 PM	Lights Out			

Friday | 2/17/2017

	Freedom Forest	Pacific Oak	Palm Grove	Val Verde Park	Fireside Reflections
Time					
7:00 AM					
8:00 AM					
9:00 AM			Coffee & chats		
10:00 AM		RBA's (Andy Hinchcliffe) Let's examine the practical process and nuanced vocabulary offered by risk-benefit assessments.	Site check Ropes, swings and hammocks (Alex Cote) With a small bag of equipment, you'll soon be dangling and spinning in the air - and learning some useful knots in the process.	Open Mic (featuring Joan Almon) Museums (Megan Dickerson) Learn about playwork practice at children's New Museum in San Diego.	
11:00 AM		Myth-busting (PANEL) Tired of hearing references to Lord of the flies? Here, we'll dismantle some common myths about adventure play, playwork, and children's play			Conversations with Jill Wood and Andy Hinchcliffe (schools)
12:00 PM		Social media (Suzanna Law) There's lots of talk about building publicity and networks online. Come on down to learn about hosting conversation across platforms.	Starting fires on purpose (Luke Sutton) From birthday candle to bonfire, we'll cover the essentials of lighting flames during sessions.		
1:00 PM	Lunch				
2:00 PM	Picnic and Play Crowd	Filming play (Erin Davis) Filming and photographing children can be respectful, inspiring and illuminating - but often isn't. Let's talk about ways to do it right.	Hammers and saws (Simon Rix) Swing a hammer, grab a saw. We'll start with the basics of hand tools, and get you ready to pass these skills on to others.		Conversations with Luke Sutton and Alex Cote (trans-Atlantic APs)
3:00 PM		Neurodiversity (Jill Wood) There are new models to discuss issues of inclusion and cognitive difference which are based upon acceptance, celebration and individualized support.			
4:00 PM		Tech & play (Chris Martin) Take a fresh look at the intersection of mobile digital technology and outdoor play.			
5:00 PM		Politics of play (Simon Rix) Lexicons of space, autodestructive art and anarchist theory... take a deep dive into radical theories of playwork.	Weapons & wrestling (TBD) Build personal comfort and team skills to support stick fighting, mud missiles, and rough and tumble.		Reflective practice (Morgan Leichter-Saxby) Team conversations, private journals, heart-to-hearts... There are many ways to reflect. Learn new techniques, and practice old favorites.
6:00 PM	Dinner				
7:00 PM	Film Screenings and Q&A with Filmmakers Erin Davis & Michele Meek, plus Fraser Brown, and Luke Sutton,				
8:00 PM	Santa Clarita Valley International Charter School (SCVI)				
9:00 PM	28060 Hasley Canyon Rd, Castaic, CA 91384				
10:00 PM	Lights out				

PROGRAM SCHEDULE CONT...

Saturday | 2/18/2017

Time	Freedom Forest	Pacific Oak	Palm Grove	Val Verde Park	Fireside Reflections
7:00 AM					
8:00 AM		Coffee & chats	Site check		
9:00 AM		Open Mic (featuring Patty Donald from the 35 yr old Adventure Playground at the Berkeley Marina)	Scavenger hunt	Play as art & process (Erica Larsen-Dockray) Creative immersion is a process that can take us to surprising places.	Conversations with Playrangers
10:00 AM		Parish AP (Jill Wood) This adventure playground in Houston, Texas has 8 years of beautiful practice, and has reached into school recess with a variety of loose parts.			
11:00 AM		HONAZ (Alex Cote) Sharing stories and images from the Hands-on-Nature Anarchy Zone in Ithaca, New York - an adventure playground summer camp which opened in YEAR.			Conversations with Prof. Fraser Brown
12:00 PM		Unions & professional community (Chris Martin) Learn about the role of a trade union in nurturing a growing profession, and about the relationship between Unite the Union and playwork in the UK.	Prizes	Loose Parts (PANEL) Celebrating the gorgeous junk we love, discussing where we find it and how we've seen them combine.	
1:00 PM	Lunch				
2:00 PM	Materials and staging for play @ Val Verde Park				
3:00 PM	Public Pop-up Adventure Playground Val Verde Park 30300 Arlington St. Val Verde, CA 91384				
4:00 PM					
5:00 PM					
6:00 PM	Dinner				
7:00 PM	Fireside Conversation and Special Celebration				
8:00 PM					
9:00 PM					
10:00 PM	Lights Out				

Sunday | 2/19/2017

Time	Freedom Forest	Pacific Oak	Palm Grove	Fireside Reflections
7:00 AM				
8:00 AM		Coffee & chats	Site check	
9:00 AM		Open Mic	Maintaining and closing a session	Addressing those Big Questions (TBD)
10:00 AM		Challenging Behaviour (PANEL) There are times when all of us have been challenged by what we've seen or felt at work. Time for real talk.	Events, programs and sites all end sometimes. We can hold them with care for as long as they last, and end them with dignity.	
11:00 AM	Keynote 2 @ Pacific Oak (Prof. Fraser Brown) Theme: Playworker Drummond Abernathy said that "adventure is in the mind of the child". What might that mean for practice?			
12:00 PM	Reflection and Evaluation - Goodbyes			
1:00 PM	Grab & Go Lunch			
2:00 PM	General Clean-up and Campsite Break Down Bonanza			
3:00 PM				
4:00 PM				
5:00 PM				
6:00 PM				
7:00 PM				
8:00 PM				
9:00 PM				

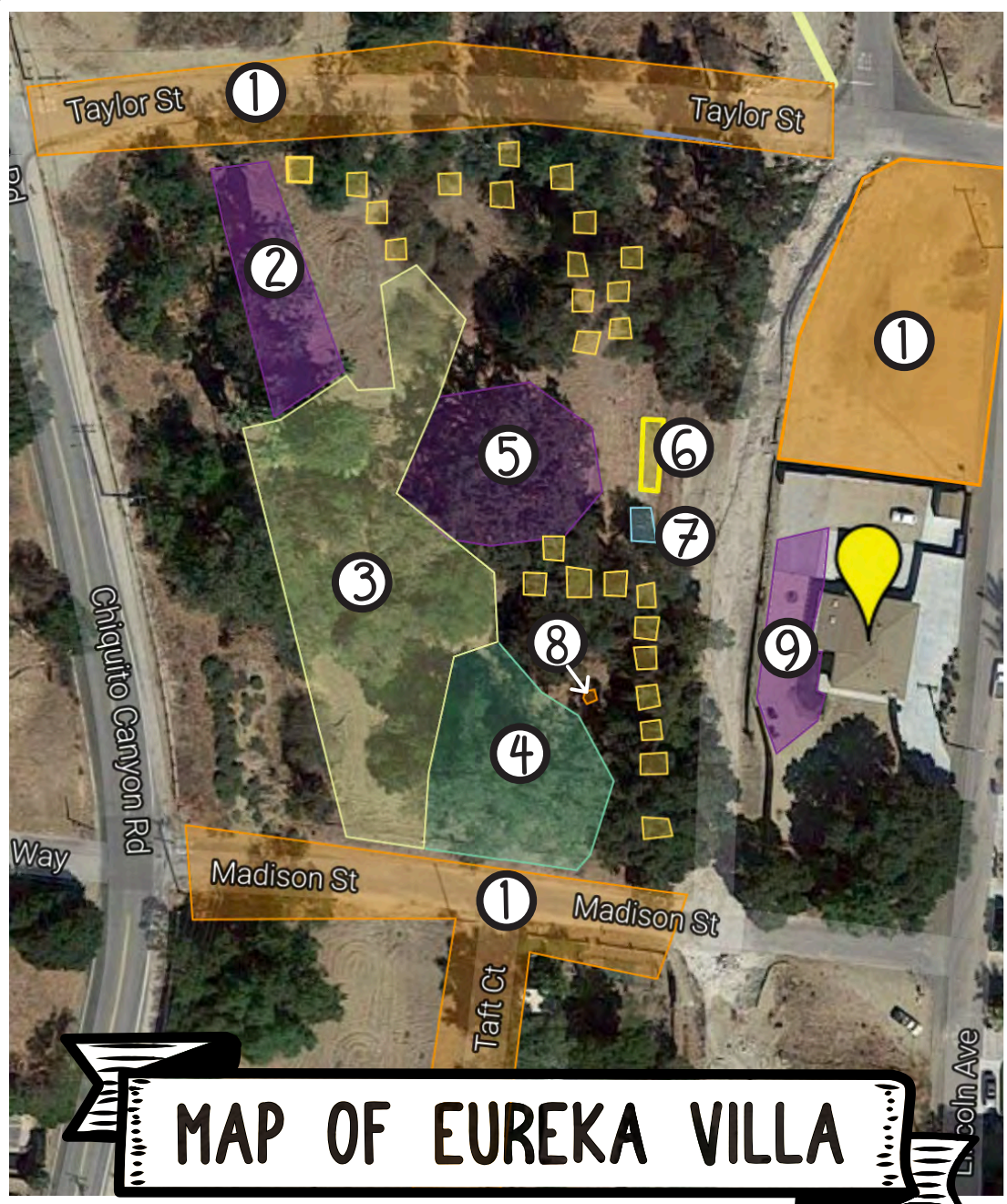
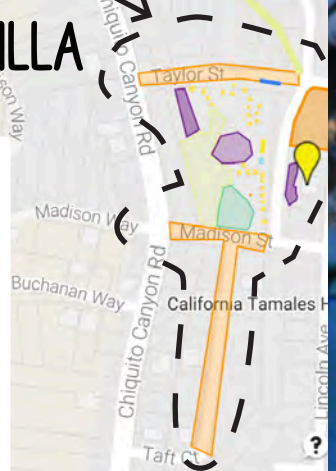
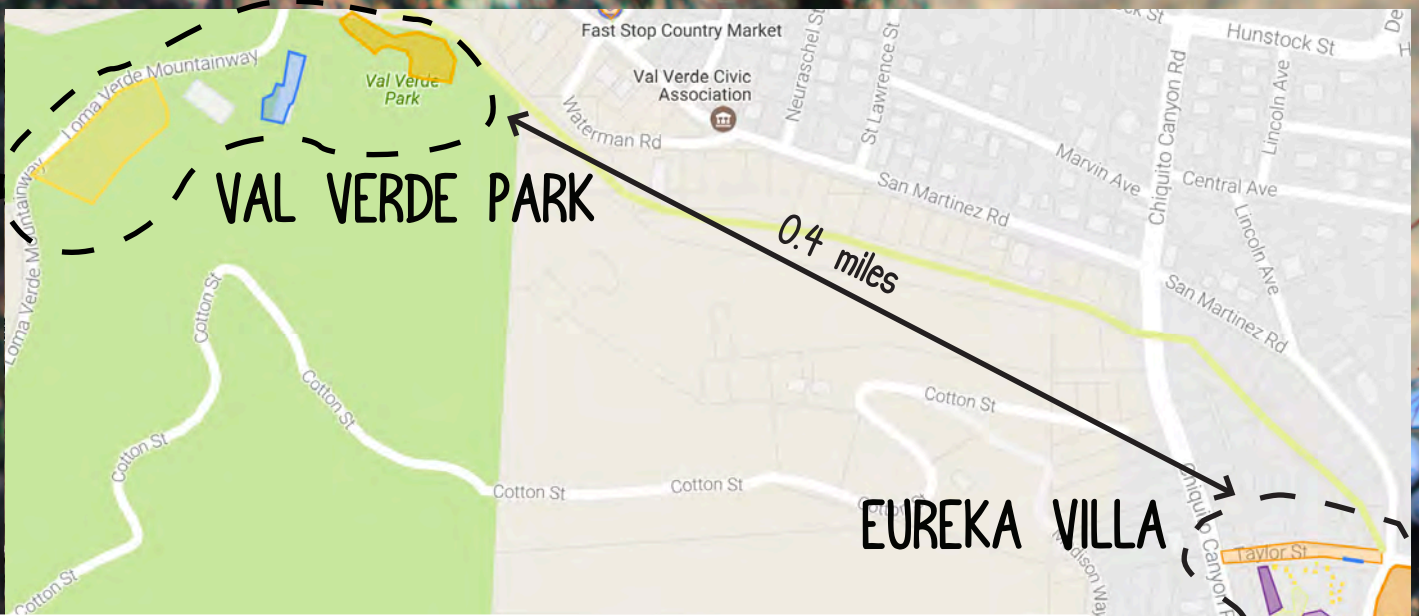

MAP OF VAL VERDE PARK

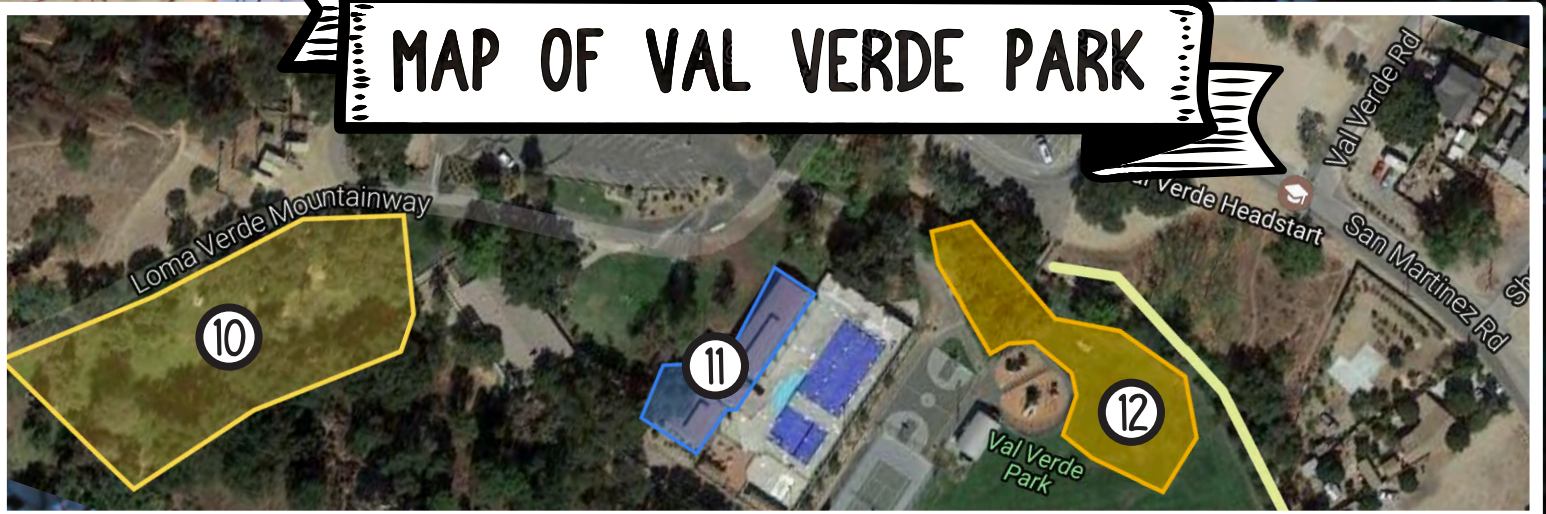

1 PARKING

2 PALM GROVE

For hands-on sessions and the chance to swing a hammer, come by the Palm Grove. You'll be in the company of giant trees standing among sand dunes. Swing in hammocks, dig in the sand dunes and enjoy a little privacy. (Gigantic, rustic, unclipped, swinging in the wind. Sand dunes weaved in-between. Popular spot for hammocks, digging, hiding, privacy, furthest point from where the adults usually congregate)

3 FREEDOM FOREST

From MORNING to EVENING, the children of Campference will be provided with loose parts, tools and support as they create their landscape for play. Adults can visit, help out the staff and shadow their playwork practice.

4 COOKING/GATHERING AREA

5 PACIFIC OAK

This is where the more theoretical or philosophical sessions will be held, seated at the heart of the site, beneath the arching branches of our enormous (and carefully protected) tree. (Focal point in the centre of EV, huge over-arching branches, stunning, magical, mystical I spent many times day-dreaming in awe - Also has more rights than an American citizen I believe)

6 RESTROOMS

7 THE BUG VAN

Meet here for the DAY's social media session (held off site), or to take a look at the Campference noticeboard.

8 FIRESIDE CIRCLE

Pull up a stump and poke the embers here, while the stories of playwork circulate around you and smoke spirals through an opening in the green canopy above. Wide-ranging conversations will be supported by trained playworkers, addressing the Big Questions (Directly under an opening in the park's green ceiling and already a focal point of the park)

9 THE PLAYWORKER PATIO

Extra meeting place

10 VAL VERDE PARK CAMP SITES

Additional Campsites

11 VAL VERDE POOL - SHOWER SITE

Through negotiation with the local Parks and Rec department we have agreed use of the showers and changing facilities at the local swimming pool. There are specific times both morning and evening when these can be accessed.

12 POP-UP ADVENTURE PLAYGROUND SITE (SAT EVENT)

A photograph of a child climbing a large, thick tree branch. The child is wearing a light blue shirt and dark pants. Another child in a green shirt is sitting on a lower branch to the right. The scene is set in a lush, green forest with sunlight filtering through the leaves.

OTHER FACILITIES

There is a small convenience store within a few minutes walking distance of both Eureka Villa and the overflow park site. They have a wide range of snacks, sandwiches, drinks, alcohol and tobacco. Please bear in mind that this is a family friendly conference in a residential area so please keep noise and disruptions to a minimum. In other words, be cool.

TRANSPORT AND ACCOMMODATIONS

If you send along your flight details, we will arrange a lift from the airport. If you need your own car during your stay, let us know you'll be making your own way.

If you are planning to spend some time in Los Angeles before your visit or would prefer to make your own way to Santa Clarita, hourly trains run between LA Union and Newhall Station, where we can also arrange transport to the site.

Arrangements have been made for you onsite, with a very limited number of AirBnB bookings nearby.

We'll take you to your accommodation when you arrive. Check the list of what to bring, and if any of it is a problem then let us know and we'll source what you need locally.

CONTACTS

Morgan Leichter-Saxby (914) 319-0994

Erica Larsen-Dockray (308) 631-5704

Suzanna Law (585) 545-5508

A large, leafy tree with a thick trunk and a child sitting on a branch. The child is wearing a green shirt and blue shorts. The tree is the central focus of the image, with its branches spreading out and its leaves creating a dense canopy. The lighting is bright, suggesting a sunny day. The text is overlaid on the right side of the image, with a white sign-like graphic for the main heading.

MANY THANKS

THIS EVENT IS MADE POSSIBLE
BECAUSE OF MANY EFFORTS BY MANY
PEOPLE. WE COULD NOT HAVE DONE IT
WITH OUT YOU. THANK YOU!

Santa Clarita Valley International Charter School (SCVi)
Al Evans & Mari Roman and LA County Parks and Recreation
Megan Dickerson and the crew from
The New Children's Museum in San Diego
Deborah Ragonig
Susie Goliti
Captain Noble Robinson and the LA County Fire Station 143-A
Thomas and Janai Leeb
Patti Larsen

Wyke Community and Children's Centre
Joan Almon and the Alliance for Childhood
Open University Press
McGraw Hill
Routledge
John Catt Bookshop
DMN Designbuild
Treasures 4 Teachers
Children's Scrapstore Salford
Bernie and Brian Hinchcliffe
A Little Patch of Earth Preschool

Jennie Hinrichs and Hector Barron
Sarah and Nino Barrette
Heidi and Mike Bunch
Joe Firmwalt and Lesley Valentine
Tanya and Greg Hauser
Maria and Nic Schellpfeffer
Meghan Talarowski
Aleigh and Sage Lewis
Jeanne McNiff-Hendzlik and Corey Hendzlik